



PART NUMBER: 6001

REVISION			
LTR.	DESCRIPTION	DATE	BY
B	REVISED PER ECN-3951	4/19/96	DPM

SERVICE INSTRUCTIONS:

MOD: 130 AND 150

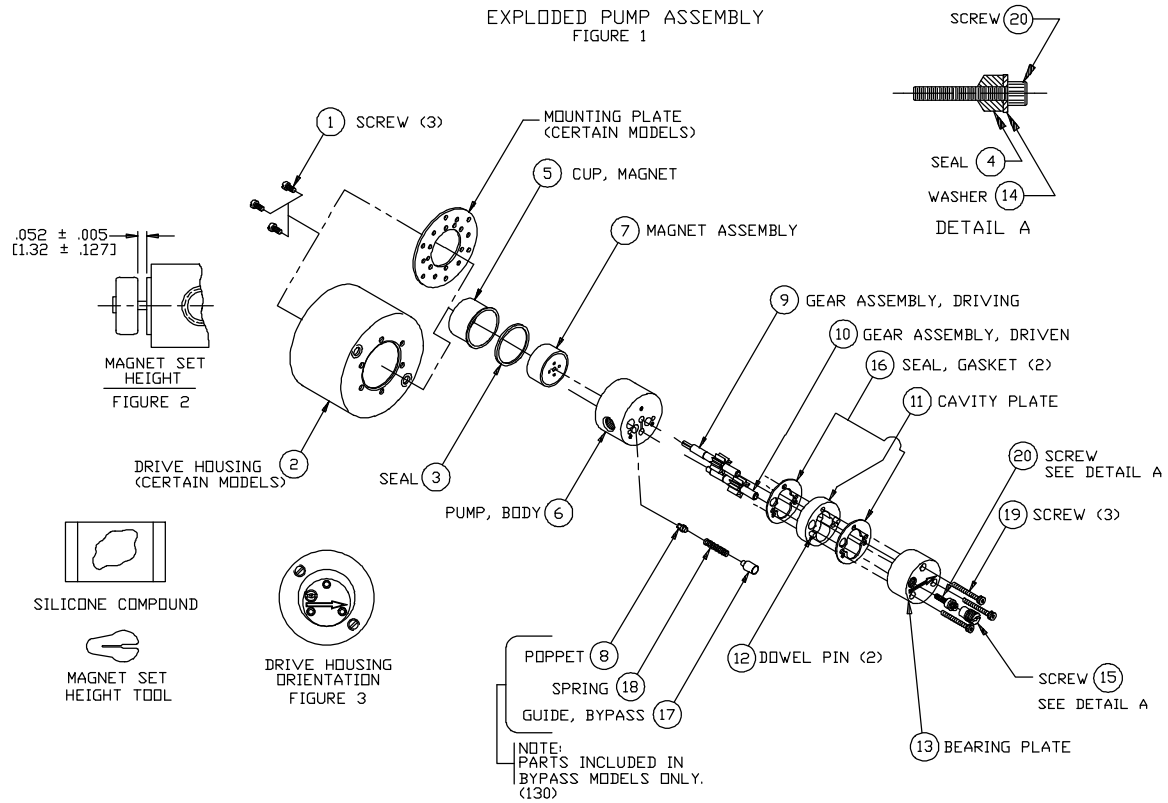

GENERAL:

1. All service work should be performed in a clean area.
2. Care should be taken to avoid scratching any sealing surfaces or allowing metal chips to come in contact with the driven magnet assembly.
3. An even, light coat of high vacuum silicone grease (Dow Corning or equiv.) should be applied to all seals or O-Rings.
4. O-Rings with chamfers should always be installed with the chamfer up, away from the groove.
5. All assembly screws should be tightened evenly and in an alternating pattern.
6. Only Micropump factory authorized replacement parts should be used when servicing any Micropump products.

SPECIFIC:

1. Install Gears (1) and (2), then Driven Magnet per Figure 1.
2. Set Driven Magnet height from Pump Body pilot as shown in Figure 2 using P/N 6009 Magnet Set Height. Slide Magnet Set Height Tool between Pump Body and Driven Magnet, press Driven Magnet down until it touches the Magnet Set Height Tool.
3. Driven Magnet and Gears must rotate freely.
4. Complete assembly of the pump per Figure 1. If assembly has Drive Housing, orient per Figure 3.

MICROPUMP, INC.

A Unit of IDEX Corporation

PO Box 8975, Vancouver, WA 98668-8975 • Phone: 360/253-2008 • Fax: 360/253-8294

MICROPUMP LIMITED

A Subsidiary of Micropump, Inc.

Forge Close, Eaton Socon, St. Neots, Cambridgeshire, PE 19 3TP England, • Phone: (44) (0) 1480-219844 • Fax: (44) (0) 1480-476959

PART NUMBER: 6001

REVISION			
LTR.	DESCRIPTION	DATE	BY
B	REVISED PER ECN-3951	4/19/96	DPM

SPARE PARTS LIST

FOR GEAR PUMP MODEL 130/150

PART NO.: 81528/81529/81530/81531

ITEM NO.	PART NO.	DESCRIPTION	UNITS PER ASSEMBLY
1	795	SCREW	3
2	5508	DRIVE HOUSING (81401, 82535 ONLY)	1
3	2619	SEAL	1
4	4956	SEAL (130 ONLY)	1
5	3279	CUP MAGNET	1
6	5437	PUMP BODY (130 ONLY)	1
6	5444	PUMP BODY (150 ONLY)	1
7	80071	MAGNET ASSEMBLY	1
8	4513	POPPET (130 ONLY)	1
9	81448	* GEAR ASSEMBLY, DRIVING	1
10	81449	*GEAR ASSEMBLY, DRIVEN	1
11	6059	CAVITY PLATE	1
12	4218	DOWEL PIN	2
13	4965	BEARING PLATE (130 ONLY)	1
13	4971	BEARING PLATE (150 ONLY)	1
14	4964	WASHER, SPRING (130 ONLY)	1
15	5059	SCREW, SEAL (130 ONLY)	1
16	5369	* + SEAL, GASKET	2
16	6063	* SEAL, GASKET	2
17	4959	GUIDE, BYPASS (130 ONLY)	1
18	1098	SPRING, BYPASS (130 ONLY)	1
19	4225	SCREW	3
20	4955	SCREW (130 ONLY)	1
	81561	* + GEAR SERVICE KIT (P/N 5369 SEAL, GASKET)	
	81894	* GEAR SERVICE KIT (P/N 6063 SEAL, GASKET)	
		* PARTS AVAILABLE IN GEAR SERVICE KIT ONLY	

Prices subject to change without notice.

MICROPUMP, INC.

A Unit of IDEX Corporation

PO Box 8975, Vancouver, WA 98668-8975 • Phone: 360/253-2008 • Fax: 360/253-8294

MICROPUMP LIMITED

A Subsidiary of Micropump, Inc.

Forge Close, Eaton Socon, St. Neots, Cambridgeshire, PE 19 3TP England, • Phone: (44) (0) 1480-219844 • Fax: (44) (0) 1480-476959