



PART NUMBER: 5477

SERVICE INSTRUCTIONS:

MOD: 040

REVISION			
LTR.	DESCRIPTION	DATE	BY
B	REVISED PER ECN-3951	1/22/96	D.M.S.

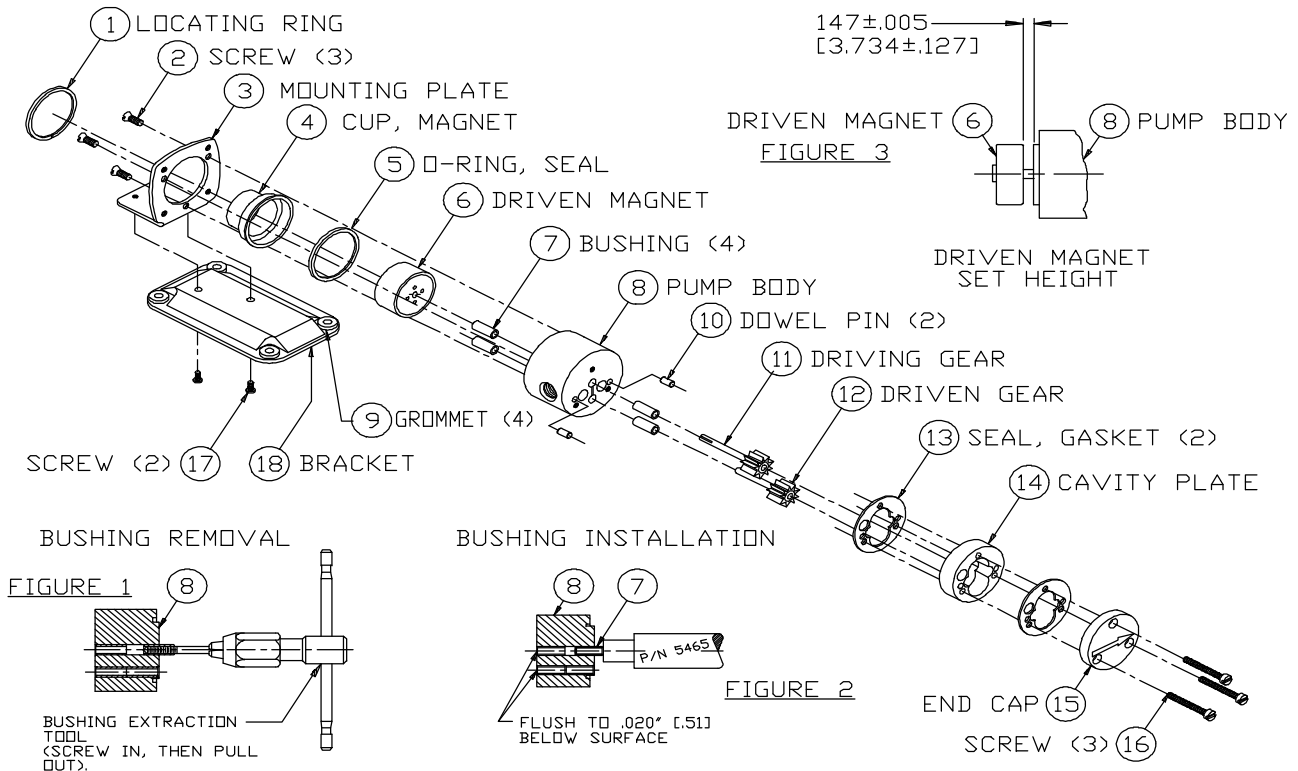

GENERAL:

1. All service work should be performed in a clean area.
2. Care should be taken to avoid scratching any sealing surfaces or allowing metal chips to come in contact with the Driven Magnet Assembly.
3. An even, light coat of high vacuum silicone grease (Dow Corning or equiv.) should be applied to all seals or O-Rings.
4. O-Rings with chamfers should always be installed with chamfer up, away from the groove.
5. All assembly screws should be tightened evenly and in an alternating pattern.
6. Only Micropump factory authorized replacement parts should be used when servicing any Micropump products.

SPECIFIC:

1. Remove old Bushings (7) with a screw extractor. (See Figure 1)
2. New Bushing installation is a press fit. Install using P/N 5465-Tool. (See Figure 2)
3. The first two Bushings should be installed into the Pump Body (8) from the gear side. These Bushings should be inserted to .020 inch (.51 mm) below seal surface. The remaining two bushings should be inserted into the Pump Body from the Driven Magnet (6) side.
4. Next install Driven Magnet (6) and Gears (11) & (12). Set Driven Magnet height from Pump Body (8) pilot as shown in Figure 3.
5. Driven Magnet and Gears must rotate freely - tight Bushings may be reamed with a #30 reamer.
6. Install Parts (1) - (5) first, then complete rest of assembly.
7. Assemble locating ring (1) with bevel facing away from Mounting Plate (3).

MICROPUMP, INC.

A Unit of IDEX Corporation

PO Box 8975, Vancouver, WA 98668-8975 • Phone: 360/253-2008 • Fax: 360/253-8294

MICROPUMP LIMITED

A Subsidiary of Micropump, Inc.

Forge Close, Eaton Socon, St. Neots, Cambridgeshire, PE 19 3TP England, • Phone: (44) (0) 1480-219844 • Fax: (44) (0) 1480-476959

