



PART NUMBER: 5027

SERVICE INSTRUCTIONS:

MOD: 12A, 14A, 121, 141

REVISION			
LTR.	DESCRIPTION	DATE	BY
B	REVISED PER ECN-3951	1/16/96	D.M.S.

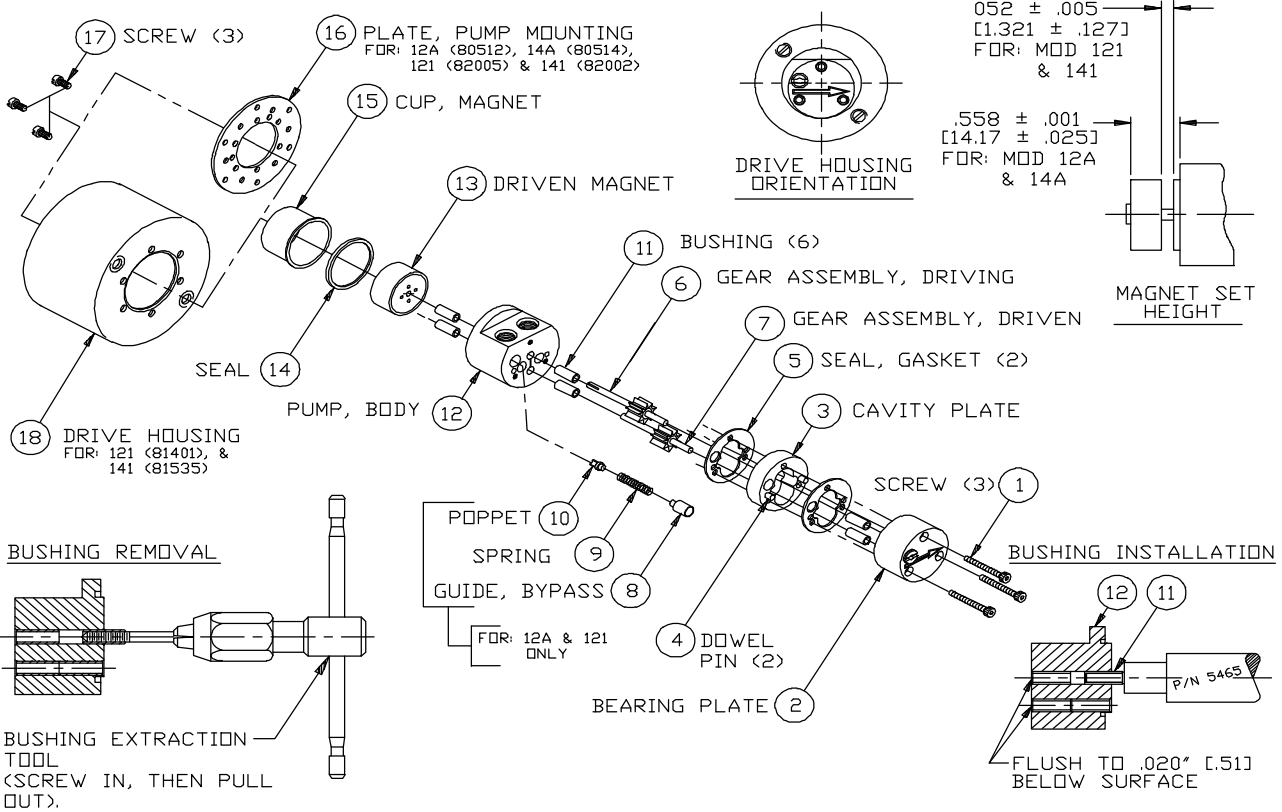

GENERAL:

- All service work should be performed in a clean area.
- Care should be taken to avoid scratching any sealing surfaces or allowing metal chips to come in contact with the driven magnet assembly.
- An even, light coat of high vacuum silicone grease (Dow Corning or equiv.) should be applied to all seals or O-Rings.
- O-Rings with chamfers should always be installed with the chamfer up, away from the groove.
- All assembly screws should be tightened evenly and in an alternating pattern.
- Only Micropump factory authorized replacement parts should be used when servicing any Micropump products.

SPECIFIC:

- Remove old Bushings (11) with Extraction Tool. The use of a #8 or M4 tap with T-Handle is recommended (See Figure 3.).
- New Bushing installation is a press fit. Install using P/N 5465 tool. (See Figure 4).
- The first two Bushings should be installed into the Pump Body (12) from the gear side. These Bushings should be inserted to .020 inch (.51mm) below seal surface. Two bushings should be inserted into the Pump Body from the Driven Magnet (13) side. The remaining two Bushings should be inserted in Bearing Plate (2).
- Next install Driven Magnet (13) and Gears (6) & (7). Set Driven Magnet height from Pump Body (12) pilot as shown in Figure 2.
- Driven Magnet and Gears must rotate freely - tight Bushings may be reamed with a #30 reamer.
- Install Parts (1) - (5) first then complete rest of assembly. Orient the Drive Housing (18) per Figure 5.

MICROPUMP, INC.

A Unit of IDEX Corporation

PO Box 8975, Vancouver, WA 98668-8975 • Phone: 360/253-2008 • Fax: 360/253-8294

MICROPUMP LIMITED

A Subsidiary of Micropump, Inc.

Forge Close, Eaton Socon, St. Neots, Cambridgeshire, PE 19 3TP England, • Phone: (44) (0) 1480-219844 • Fax: (44) (0) 1480-476959

<b>PART NUMBER:</b>	5027
---------------------	------

<b>REVISION</b>			
LTR.	DESCRIPTION	DATE	BY
B	REVISED PER ECN-3951	1/16/96	D.M.S.

**SPARE PARTS LIST**

FOR GEAR PUMP MODEL: 121, 141, 12A, 14A,

P/N.: 12A/14A (80512/80514) 121 (81401, 82005), 141 (81535, 82002)

<b>ITEM NO.</b>	<b>PART NO.</b>	<b>DESCRIPTION</b>	<b>UNITS PER ASSEMBLY</b>
1	4225	SCREW	3
2	80491	BEARING PLATE (80512, 81401, 82005 ONLY)	1
2	4971	BEARING PLATE (80514, 81535, 82002 ONLY)	1
3	4976	CAVITY PLATE	1
4	4218	DOWEL PIN	2
5	5369	* SEAL, GASKET	2
6	80505	* GEAR ASSEMBLY, DRIVING	1
7	80504	* GEAR ASSEMBLY, DRIVEN	1
8	4959	GUIDE, BYPASS (80512, 81401, 82002 ONLY)	1
9	1098	SPRING, BYPASS (80512, 81401, 82002 ONLY)	1
10	4513	POPPET, BYPASS (80512, 81401, 82002 ONLY)	1
11	4913	* BUSHING	6
12	4207	PUMP BODY (80512 ONLY)	1
12	4460	PUMP BODY (80514 ONLY)	1
12	5437	PUMP BODY (81401, 82005 ONLY)	1
12	5444	PUMP BODY (81535, 82002 ONLY)	1
13	80071	MAGNET ASSEMBLY (81401, 81535, 82002, 82005 ONLY)	1
14	2619	SEAL, O'RING	1
15	2507	CUP, MAGNET (80512, 80514 ONLY)	1
15	3279	CUP, MAGNET (81401, 81535, 82002, 82005 ONLY)	1
16	2301	PLATE, PUMP MOUNTING (80512, 80514, 82002, 82005 ONLY)	1
17	795	SCREW	3
18	5508	HOUSING (81401, 81535 ONLY)	1
	80569	GEAR SERVICE KIT	
	5465	BUSHING INSERTION TOOL	
	4973	HEX ADJUSTING WRENCH-BYPASS (80512, 81401, 82005 ONLY)	
		* Parts available in Gear Service Kit only.	

Prices subject to change without notice.

**MICROPUMP, INC.**

**A Unit of IDEX Corporation**

PO Box 8975, Vancouver, WA 98668-8975 • Phone: 360/253-2008 • Fax: 360/253-8294

**MICROPUMP LIMITED**

**A Subsidiary of Micropump, Inc.**

Forge Close, Eaton Socon, St. Neots, Cambridgeshire, PE 19 3TP England, • Phone: (44) (0) 1480-219844 • Fax: (44) (0) 1480-476959